



CONNECTORS

TRI-CLAMP FITTINGS

Elbow 45°	36
Elbow 90°	37
Clamp T-Piece, equal	38
Clamp T-Piece, short branch	39
Concentric Clamp Reducer	40
Reduced TC-Adapter	41
TC-Internal Thread-Adapter	42
TC-External Thread-Adapter	43



TRI-CLAMP FITTINGS

Elbow 45°

Product group:	Tri-Clamp Fittings
Title:	Elbow 45°
Valid standards:	45° Elbow acc. DIN 11865, TC acc. DIN 32676, ASME BPE 2009
Material:	Strn.-W. 1.4435 BN2 (Fe < 0,5%) acc. EN 10088
Sterelizing temperature:	150°C
Type of construction / Surface quality:	Surface inside: sanded and polished. RA inside < 0,6 µm Elbow surface outside: bright finish. Welding seam: Annealing color removed.
Pipe-Hygienic Classes:	H 3 acc. DIN 11866
Marking:	Size, Material, Batch-Number, Producer
Certificates:	Certificate acc. EN 10204-3.1
Tolerances:	Measures x / y: +/- 2mm
Option:	Electropolishing. Further dimensions on request available.
Remarks:	Technical contents are subject to change

Dimension for Elbow 45°							
Sizes	A	AD	ID	x	y	Item-Number	
acc. DIN 32676 Row B, ISO 1127							
ISO DN 8	25.0	13.5	10.3	43.7	105.5	252.145.008	
ISO DN 10	25.0	17.2	14.0	46.0	111.1	252.145.010	
ISO DN 15	50.5	21.3	18.1	41.7	100.7	252.145.015	
ISO DN 20	50.5	26.9	23.7	51.9	125.3	252.145.020	
ISO DN 25	50.5	33.7	29.7	54.7	132.0	252.145.025	
ISO DN 32	64.0	42.4	38.4	57.5	138.8	252.145.032	
ISO DN 40	64.0	48.3	44.3	60.2	145.4	252.145.040	
ISO DN 50	77.5	60.3	56.3	65.8	158.9	252.145.050	
ISO DN 65	91.0	76.1	72.1	82.0	198.0	252.145.065	
acc. DIN 32676 Row C, ASME-BPE 2009							
OD 1/2"	25.0	12.7	9.4	60.6	146.3	252.105.025	
OD 3/4"	25.0	19.05	15.75	60.6	146.3	252.107.025	
OD 1"	50.5	25.4	22.1	55.7	134.5	252.110.050	
OD 1 1/2"	50.5	38.1	34.8	60.2	145.3	252.015.050	
OD 2"	64.0	50.8	47.5	69.2	167.0	252.120.064	
OD 2 1/2"	77.5	63.5	60.2	75.9	183.2	252.125.077	
OD 3"	91.0	76.2	72.9	80.4	194.1	252.130.091	
OD 4"	119.0	101.6	97.4	96.1	232.0	252.140.119	

TRI-CLAMP FITTINGS

Elbow 90°

Product group:	Tri-Clamp Fittings
Title:	Elbow 90°
Valid standards:	90° Elbow acc. DIN 11865, TC acc. DIN 32676, ASME BPE 2009
Material:	Stnr.-W. 1.4435 BN2 (Fe < 0,5%) acc. EN 10088
Sterelizing temperature:	150°C
Type of construction / Surface quality:	Surface inside: sanded and polished. RA inside < 0,6 µm Elbow surface outside: bright finish. Welding seam: Annealing color removed.
Pipe-Hygienic Classes:	H 3 acc. DIN 11866
Marking:	Size, Material, Batch-Number, Producer
Certificates:	Certificate acc. EN 10204-3.1
Tolerances:	Measure Z: +/- 2mm
Option:	Electropolishing
Remarks:	Technische Änderungen vorbehalten

Dimension for Elbow 90°							
Sizes	A	AD	ID	Z	Item-Number		
acc. DIN 32676 Row B, ISO 1127							
ISO DN 6	25.0	10.2	7.0	43.1	**252.050.006		
ISO DN 8	50.5	13.5	10.3	66.6	252.050.008		
ISO DN 10	50.5	17.2	14.0	74.6	252.050.010		
ISO DN 15	50.5	21.3	18.1	76.6	252.045.015		
ISO DN 20	50.5	26.9	23.7	90.1	252.045.020		
ISO DN 25	50.5	33.7	29.7	99.6	252.045.025		
ISO DN 32	64.0	42.4	38.4	109.1	252.045.032		
ISO DN 40	64.0	48.3	44.3	118.6	252.045.040		
ISO DN 50	77.5	60.3	56.3	137.6	252.045.050		
ISO DN 65	91.0	76.1	72.1	171.6	252.045.065		
acc. DIN 32676 Row C, ASME-BPE 2009							
OD 1/2"	25.0	12.7	9.4	104.7	252.005.025		
OD 3/4"	25.0	19.05	15.75	104.7	252.007.025		
OD 1"	50.5	25.4	22.1	97.8	252.010.050		
OD 1 1/2"	50.5	38.1	34.8	116.9	252.015.050		
OD 2"	64.0	50.8	47.5	142.3	252.020.064		
OD 2 1/2"	77.5	63.5	60.2	161.4	252.025.077		
OD 3"	91.0	76.2	72.9	180.4	252.030.091		
OD 4"	119.0	101.6	97.4	224.8	252.040.119		
**90° Elbow is made from block-body							

TRI-CLAMP FITTINGS

Clamp T-Piece, equal

Product group:	Tri-Clamp Fittings
Title:	Clamp T-Piece, equal
Valid standards:	T-Piece acc. DIN 11865, TC acc. DIN 32676, ASME BPE 2009
Material:	Stnr.-W. 1.4435 BN2 acc. EN 10088
Sterelizing temperature:	150°C
Type of construction / Surface quality:	Surface inside: sanded and polished. RA inside < 0,6 µm T-Piece surface outside: bright finish. Welding seam: Annealing color removed.
Pipe-Hygienic Classes:	H 3 acc. DIN 11866
Marking:	Size, Material, Batch-Number, Producer
Certificates:	Certificate acc. EN 10204-3.1
Tolerances:	Measure L1= +/- 2mm
Option:	Electropolishing
Remarks:	Technical contents are subject to change

Dimensions for Clamp T-Piece, equal							
Sizes	A	AD	ID	L1	Item-Number		
acc. DIN 32676 Row B, ISO 1127							
ISO DN 6	25.0	10.2	7.0	36.5	**253.050.006		
ISO DN 8	25.0	13.5	10.2	60.5	253.050.008		
ISO DN 10	25.0	17.2	15.0	62.5	253.050.010		
ISO DN 10	50.5	17.2	14.0	55.6	253.100.010		
ISO DN 15	50.5	21.3	18.1	57.6	253.045.015		
ISO DN 20	50.5	26.9	23.7	76.6	253.045.020		
ISO DN 25	50.5	33.7	29.7	81.6	253.045.025		
ISO DN 32	64.0	42.4	38.4	86.6	253.045.032		
ISO DN 40	64.0	48.3	44.3	86.6	253.045.040		
ISO DN 50	77.5	60.3	56.3	111.6	253.045.050		
ISO DN 65	91.0	76.1	72.1	131.6	253.045.065		
ISO DN 80	106.0	88.9	84.3	151.6	253.045.080		
ISO DN 100	130.0	114.3	109.7	181.6	253.045.100		
acc. DIN 32676 Row C, ASME-BPE 2009							
OD 1/2"	25.0	12.7	9.4	76.1	253.005.025		
OD 3/4"	25.0	19.05	15.75	79.3	253.007.025		
OD 1"	50.5	25.4	22.1	75.6	253.010.050		
OD 1 1/2"	50.5	38.1	34.8	81.9	253.015.050		
OD 2"	64.0	50.8	47.5	94.6	253.020.064		
OD 2 1/2"	77.5	63.5	60.2	101.0	253.025.077		
OD 3"	91.0	76.2	72.9	107.3	253.030.091		
OD 4"	119.0	101.6	97.4	126.4	253.040.119		

**made from block-body

TRI-CLAMP FITTINGS

Clamp T-Piece, short branch

Product group:	Tri-Clamp Fittings
Title:	Clamp T-Piece, short branch
Valid standards:	T-Piece acc.DIN 11865, TC acc. DIN 32676, ASME BPE 2009
Material:	Strn.-W. 1.4435 BN2 acc. EN 10088
Sterelizing temperature:	150°C
Type of construction / Surface quality:	Surface inside: sanded and polished. RA inside < 0,6 µm T-Piece surface outside: bright finish. Welding seam: Annealing color removed.
Pipe-Hygienic Classes:	H 3 acc. DIN 11866
Marking:	Size, Material, Batch-Number, Producer
Certificates:	Certificate acc. EN 10204-3.1
Tolerances:	Measures L1 / L2: +/- 2mm
Option:	Electropolishing
Remarks:	Technical contents are subject to change

Dimensions for T-Piece, short branch							
Sizes	A	AD	ID	L1	L2	Item-Number	
acc. DIN 32676 Row B, ISO 1127							
ISO DN 8	25.0	13.5	10.3	60.5	39.9	253.145.008	
ISO DN 10	25.0	17.2	14.0	62.5	39.9	253.145.010	
ISO DN 15	50.5	21.3	18.1	57.6	33.8	253.145.015	
ISO DN 20	50.5	26.9	23.7	76.6	37.1	253.145.020	
ISO DN 25	50.5	33.7	29.7	81.6	40.5	253.145.025	
ISO DN 32	64.0	42.4	38.4	86.6	45.3	253.145.032	
ISO DN 40	64.0	48.3	44.3	86.6	48.8	253.145.040	
ISO DN 50	77.5	60.3	56.3	111.6	55.8	253.145.050	
ISO DN 65	91.0	76.1	72.1	131.6	64.7	253.145.065	
acc. DIN 32676 Row C, ASME-BPE 2009							
OD 1/2"	25.0	12.7	9.4	76.1	39.9	253.105.025	
OD 3/4"	25.0	19.05	15.75	79.3	39.5	253.107.025	
OD 1"	50.5	25.4	22.1	75.6	35.8	253.110.050	
OD 1 1/2"	50.5	38.1	34.8	81.9	42.2	253.115.050	
OD 2"	64.0	50.8	47.5	94.6	50.0	253.120.064	
OD 2 1/2"	77.5	63.5	60.2	101.0	57.4	253.125.077	
OD *3"	91.0	76.2	72.9	107.3	64.7	253.130.091	
OD 4"	119.0	101.6	97.4	126.4	77.4	253.140.119	

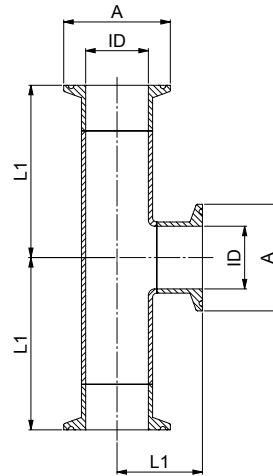

TRI-CLAMP FITTINGS

Concentric Clamp Reducer

Product group:	Tri-Clamp Fittings
Title:	Concentric Clamp Reducer
Valid standards:	DIN 32676 Row B (ISO 1127) DIN 32676 Row C (ASME BPE 2009)
Material:	Strn.-W. 1.4435 BN2 (Fe < 0,5%) acc. EN 10088
Sterelizing temperature:	150°C
Type of construction / Surface quality:	Inside and outside surface: bright finish. Buttweld-Ends for orbital-welding. Ra inside < 0,4 µm.
Pipe-Hygienic Classes:	H 3 / H 4 acc. DIN 11866
Marking:	Size, Material, Batch-Number, Producer
Certificates:	Certificate acc. EN 10204-3.1
Option:	Electropolishing. Other dimensions on request.
Remarks:	Technical contents are subject to change

Dimensions for Concentric Clamp Reducer							
Sizes	A	ID	ad	id	L	Item-Number	
acc. DIN 32676 Row B (ISO 1127) / DIN 32676 Row C (ASME BPE 2009)							
ISO DN 15 / 8	50.5	18.1	13.5	10.3	35.0	257.181.135	
ISO DN 20 / 10	50.5	23.7	17.2	14.0	35.0	257.237.172	
ISO DN 25 / 10	50.5	29.7	21.3	18.1	35.0	257.297.213	
BS 1-1/2" / 1"	50.5	34.8	25.4	22.1	35.0	257.344.254	
ISO DN* 15 / 8	64.0	18.1	13.5	10.3	35.0	257.064.135	
ISO DN* 20 / 10	64.0	23.7	17.2	14.0	35.0	257.004.172	

Reduced TC-Adapter

Product group:	Tri-Clamp Fittings
Title:	Reduced TC-Adapter
Valid standards:	DIN 32676 Row A (DIN 11850) DIN 32676 Row C (ASME BPE 2009) / *non standard
Material:	Strn.-W. 1.4435 BN2 (Fe < 0,5%) acc. EN 10088
Sterelizing temperature:	150°C
Type of construction / Surface quality:	Inside and outside surface: bright finish Ra inside < 0,4 µm (ID≤9.0=Ra<0,6µm)
Pipe-Hygienic Classes:	H 3 / H 4 acc. DIN 11866
Marking:	Size, Material, Batch-Number, Producer
Certificates:	Certificate acc. EN 10204-3.1
Option:	Electropolishing. Further dimensions on request available.
Remarks:	Technical contents are subject to change

Dimensions for Reduced TC-Adapter						
Sizes	A	a	ID	id	L	Item-Number
ISO 1127 / DIN 11850						
DIN 15 / 08	50.5	25.0	18.1	8.0	30.0	225.181.008
DIN 20 / 15	50.5	25.0	23.0	16.0	30.0	225.230.016
DIN *20 / ISO 08	64.0	25.0	23.0	10.3	30.0	225.230.010
DIN *20 / DIN 15	64.0	25.0	23.0	16.0	30.0	225.023.016
DIN *40 / DIN 15	64.0	25.0	44.0	16.0	35.0	225.440.016

The drawing shows a cross-section of the adapter. Dimension A is the total length. ID is the inner diameter of the larger section. id is the inner diameter of the smaller section. a is the thickness of the flange. L is the length of the smaller section.

TC-Internal Thread-Adapter

Product group:	Tri-Clamp Fittings
Title:	TC-Internal Thread-Adapter
Valid standards:	TC acc. DIN 32676, Thread acc. ISO 228-1
Material:	Strn.-W. 1.4435 BN2 (Fe < 0,5%) acc. EN 10088
Sterelizing temperature:	150°C
Type of construction / Surface quality:	Surface outside: Ra < 0,8 µm Surface inside: Ra < 0,4 µm
Pipe-Hygienic Classes:	H 3 / H 4 acc. DIN 11866
Marking:	Material number, melt number, manufacturer code, threading size
Certificates:	Certificate acc. EN 10204-3.1
Option:	Electropolishing. Upon request, transition facets can be turned
Remarks:	Technical contents are subject to change

Dimensions for TC-Internal Thread-Adapter							
Sizes	L1	A	ID	L	SW	Item-Number	
TC acc. DIN 32676, Thread acc. ISO 228-1							
IG 05 G	1/8	12.0	25.0	8.6	30.0	17	263.005.025
IG 1 G	1/8	12.0	50.5	8.6	30.0	24	263.010.050
IG 05 G	1/4	12.0	25.0	11.5	30.0	17	263.007.025
IG 2 G	1/4	12.0	50.5	11.5	30.0	24	263.020.050
IG 2 G	1/4	12.0	64.0	11.5	30.0	24	263.020.064
IG 3 G	3/8	12.0	25.0	12.0	30.0	17	263.030.025
IG 3 G	3/8	12.0	50.5	15.0	30.0	24	263.030.050
IG 3 G	1/2	14.0	34.0	18.6	30.0	24	263.030.034
IG 3 G	1/2	14.0	50.5	18.6	30.0	24	263.030.070
IG 4 G	3/4	14.5	50.5	24.1	30.0	34	263.040.050
IG 5 G	1	22.0	50.5	30.3	35.0	34	263.050.050
IG 5 G	1	17.0	64.0	30.3	35.0	34	263.050.064
IG 6 G	1-1/4	17.0	64.0	39.0	35.0	46	263.064.050
IG 7 G	1-1/2	20.0	64.0	44.8	40.0	50	263.038.064
IG 8 G	2	25.0	77.5	56.5	40.0	65	263.070.077

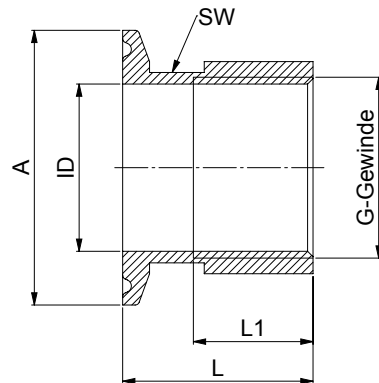

TC-External Thread-Adapter

Product group:	Tri-Clamp Fittings
Title:	TC-External Thread-Adapter
Valid standards:	TC acc. DIN 32676, Thread acc. ISO 228-1
Material:	Strn.-W. 1.4435 BN2 (Fe < 0,5%) nach EN 10088
Sterelizing temperature:	150°C
Type of construction / Surface quality:	Surface outside: Ra outside < 0,8 µm Surface inside: Ra inside < 0,4 µm (ID≤9.0=Ra<0,6µm, ID≤6.0=Ra<0,8µm)
Pipe-Hygienic Classes:	H 3 / H 4 acc. DIN 11866
Marking:	Material number, melt number, manufacturer code, threading size
Certificates:	Certificate acc. EN 10204-3.1
Option:	Electropolishing Upon request, transition facets can be turned
Remarks:	Technical contents are subject to change

Dimensions for TC-External Thread-Adapter							
Sizes	L1	A	ID	L	SW	Item-Number	
TC acc. DIN 32676, Thread acc. ISO 228-1							
AG 05 G	1/8	10.0	25.0	5.6	30.0	12	265.010.025
AG 1 G	1/8	10.0	50.5	5.6	30.0	12	265.010.050
AG 05 G	1/4	10.0	25.0	8.6	30.0	17	265.005.025
AG 2 G	1/4	10.0	50.5	8.6	30.0	17	265.020.050
AG 3 G	3/8	12.0	25.0	12.1	30.0	17	265.030.025
AG 3 G	3/8	12.0	50.5	12.1	30.0	17	265.030.050
AG 3 G	1/2	13.0	50.5	15.8	30.0	22	265.030.070
AG 3 G	1/2	13.0	64.0	15.8	30.0	22	265.030.064
AG 4 G	3/4	18.0	50.5	21.7	35.0	27	265.040.050
AG 4 G	3/4	18.0	64.0	21.7	35.0	27	265.040.064
AG 5 G	1	21.0	50.5	26.8	41.0	34	265.050.050
AG 6 G	1-1/4	20.0	50.5	35.5	35.0	38	265.060.050
AG 7 G	1-1/2	22.0	50.5	34.8	40.0	41	265.038.050
AG 8 G	2	20.0	77.5	47.5	40.0	60	265.070.077

